

Fixture #

SPECIFICATIONS:

Triple compartment surgeon scrub station, exposed surfaces finished to a satin finish. Removable divider. Removable front access panel. Radius coved bowl corners.

OVERALL DIMENSIONS:

Left to Right: 88" (224cm)
Front to Back: 23" (58cm)

BOWL DIMENSIONS:

Left to Right: 28" (72cm)
Front to Back: 16 1/4" (41cm)
Bowl depth: 11 3/16" (28cm)

MATERIAL:

16 gauge, 18-10 stainless steel
304 Series

WASTE:

3 1/2" grid strainer assembly with tailpiece included
Location: Center

HOLE DRILLINGS:

All Surgeon Scrub Stations are punched to the customer's specification. Please provide a sketch of the faucet hole requirements including:

- The location of where the faucet hole(s) is required including dimensions
- Diameter of the hole(s)

Please note that once punched with faucet holes, all Surgeon Scrub Stations are non-returnable.

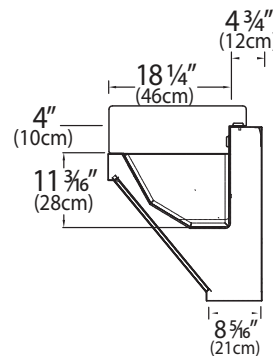
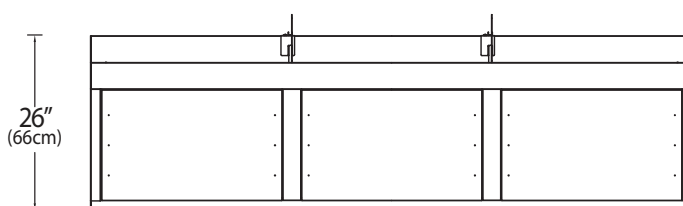
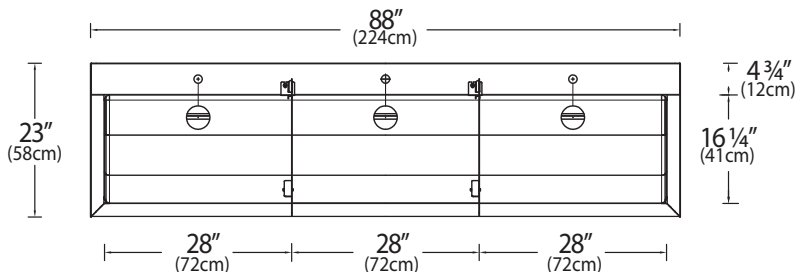

PROJECT INFORMATION:

Item Location:
Project Number:
Project Name:
Quote Number:
Faucet Model:
Notes:

Engineer's Approval

Novanni has a policy of continuous improvement.
All product specifications may change without notice.